

GENERAL NOTES & CONSTRUCTION SPECIFICATIONS

- 1.0 GENERAL NOTES**
- THIS PLAN ARE NOT TO BE WHOLE OR PARTLY REPLICATED WITHOUT THE AUTHORIZATION OF GRIT ENGINEERING INC.
 - ALL CONSTRUCTION WORK TO BE COMPLETED IN ACCORDANCE WITH ALL APPLICABLE (MOST RECENT) STANDARDS.
 - THIS PLAN PREPARED BY GRIT ENGINEERING INC. ARE NOT TO BE USED FOR CONSTRUCTION UNTIL SIGNED BY THE ENGINEER AND ACCEPTED BY THE APPROVING AGENCY.
 - CHANGES TO THE DRAWING ARE NOT PERMITTED UNTIL REVIEWED AND APPROVED BY THE ENGINEER AND ACCEPTED BY THE APPROVING AUTHORITY.
 - CONTRACTOR TO VERIFY THAT THE DRAWINGS BEING USED FOR THE CONSTRUCTION ARE THE MOST RECENT VERSION.
 - UTILITY LOCATES AND ALL APPLICABLE PERMITS ARE TO BE OBTAINED PRIOR TO THE START OF CONSTRUCTION AND INSPECTION BEING COMPLETED.
 - THE CONTRACTOR IS TO VERIFY THE EXISTING CONDITION OF THE SITE. THE VERIFICATION INCLUDES AND NOT LIMITED TO THE SERVICE LOCATION, SERVICE ELEVATIONS, UTILITY CONFLICTS AND BENCHMARK ELEVATIONS. ANY DISCREPANCIES ARE TO BE REPORTED TO THE ENGINEER IMMEDIATELY AND PRIOR TO THE CONTINUATION OF CONSTRUCTION.
 - THE TOPOGRAPHICAL AND LEGAL BOUNDARY ILLUSTRATED ON THE PLAN(S) ARE TAKEN FROM PLAN PREPARED BY GRIT ENGINEERING INC. DATED OCTOBER 2023.
 - THE CONTRACTOR IS TO OBTAIN CONSENT FROM THE NEIGHBOR IN THE FORM OF WRITTEN CORRESPONDENCE GRANTING PERMISSION TO ENTERING THE PROPERTY TO COMPLETE ANY CONSTRUCTION ACTIVITY. THE WRITTEN CONSENT IS TO BE PROVIDED TO THE APPROVING AUTHORITY PRIOR TO THE CONTINUATION OF WORK FOR APPROVAL. THE CONTRACTOR WILL ASSUME LIABILITY FOR ALL WORKS IF FAILURE TO COMPLY.
 - THIS DRAWING IS TO BE READ COMBINATION WITH THE FOLLOWING:
 - STORMWATER MANAGEMENT LETTER, OCTOBER 20, 2023.
 - DURING THE CONSTRUCTION, THE CONTRACTOR ASSUMES ALL LIABILITY FOR DAMAGE TO ALL EXISTING FEATURES AND STRUCTURES. THE CONTRACTOR WILL BE RESPONSIBLE FOR ALL RESTORATION AND RESTORED TO EXISTING CONDITION OR BETTER.

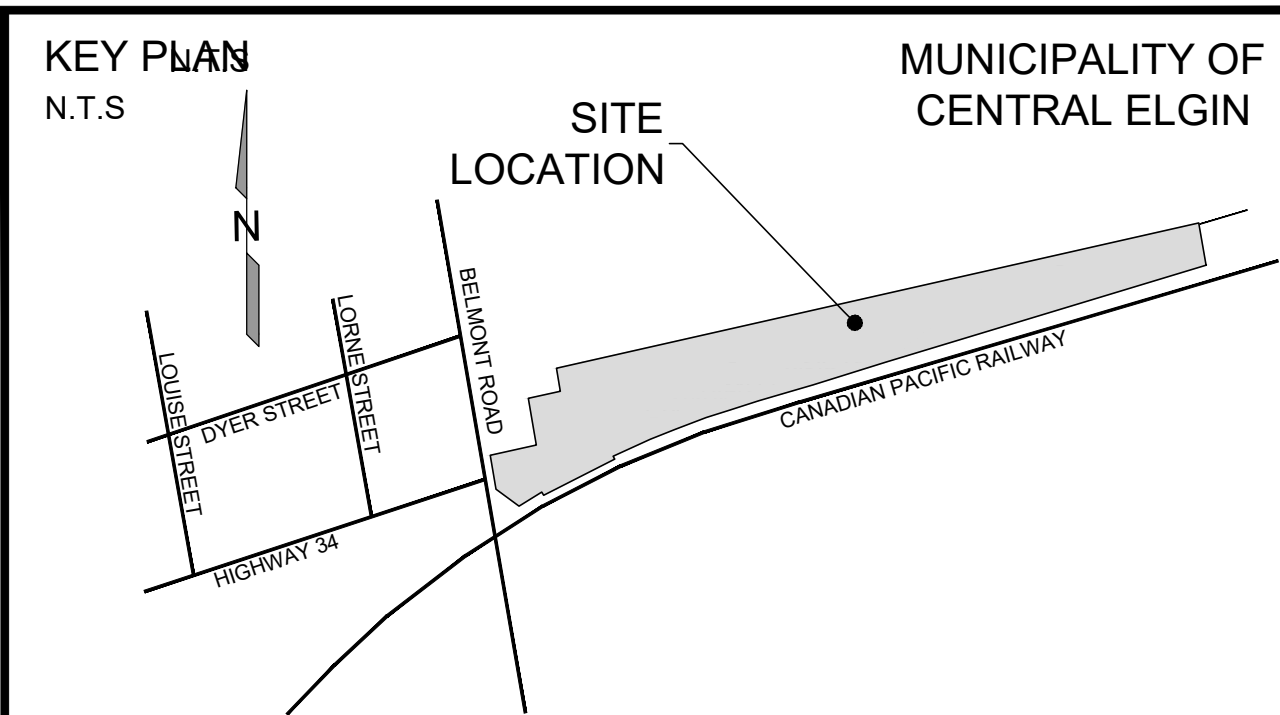
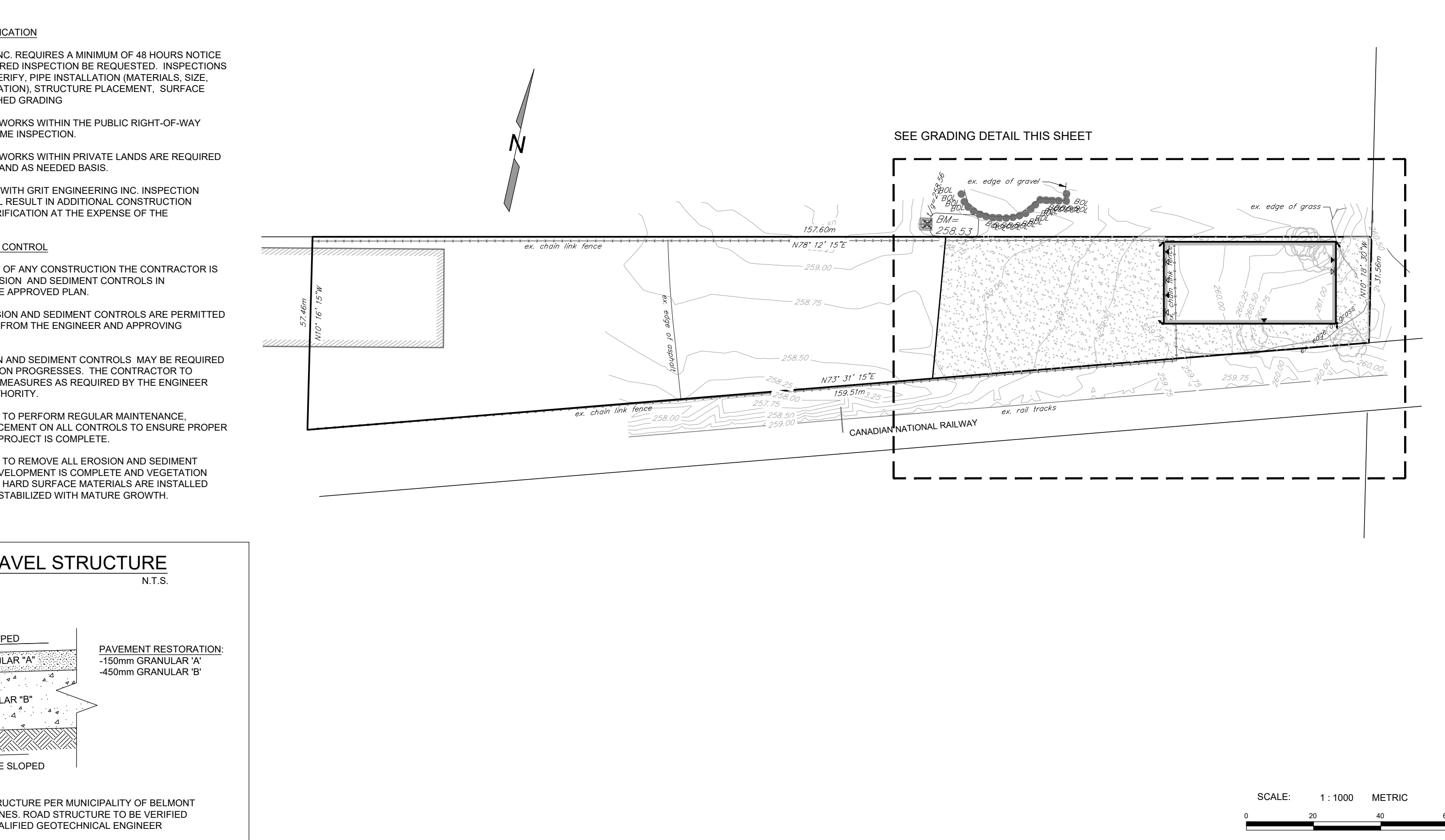
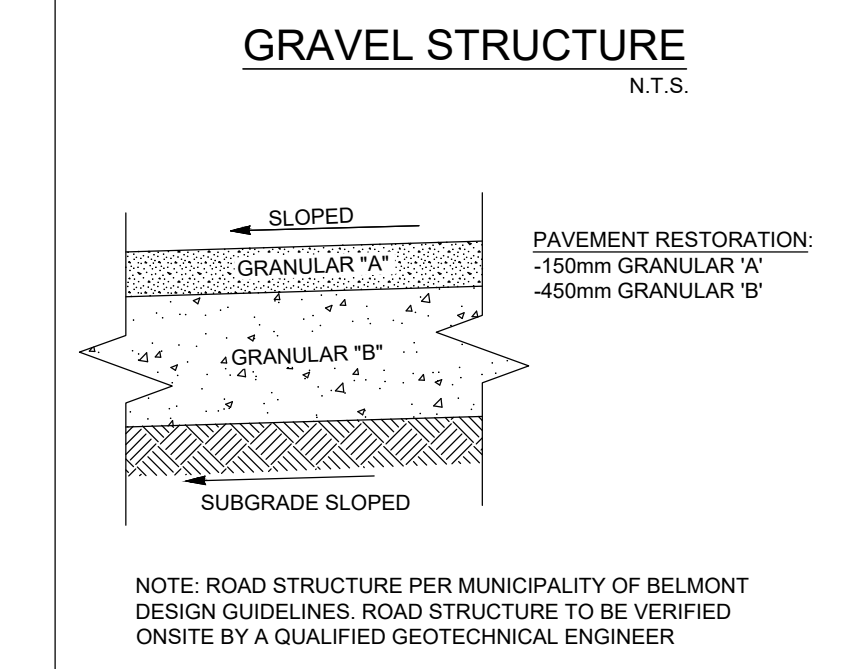

CONTRACTOR NOTES:
CONTRACTORS MUST CHECK AND VERIFY ALL DIMENSIONS AND REPORT ANY ERRORS TO THE ENGINEER PRIOR TO COMMENCEMENT OF WORK.

ALL DRAWINGS SHALL REMAIN THE PROPERTY OF THE ENGINEER AND SHALL NOT BE REUSED WITHOUT THE ENGINEER'S WRITTEN PERMISSION. DRAWING SHOULD NOT BE SCALED FOR DIMENSIONS PURPOSES.

THIS IS NOT A PLAN OF SURVEY AND SHALL NOT BE USED EXCEPT FOR THE PURPOSES INDICATED. BEARING AND DISTANCES SHOWN WERE DERIVED FROM DEPOSITED PLAN No. 11R-10276.

BENCHMARK (GEODETIC)
ELEVATIONS ARE GEODETIC, NAD83 CSRS(2010) AND ARE DERIVED FROM THE CANSEL CAN-NET REAL TIME NETWORK.

ELEVATION:

BENCHMARK (SITE)
BENCHMARK IS DESCRIBED AS CUT CROSS ON CATCHBASIN (AS SHOWN ON THE PLAN).

ELEVATION: 258.537m

No.	ISSUED DESCRIPTION	DATE (YYYY-MM-DD)
1	ISSUED FOR APPROVAL	2023-10-20
2		
3		
4		
5		
6		

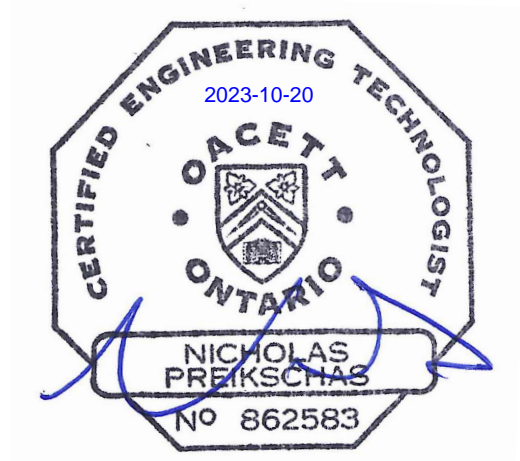
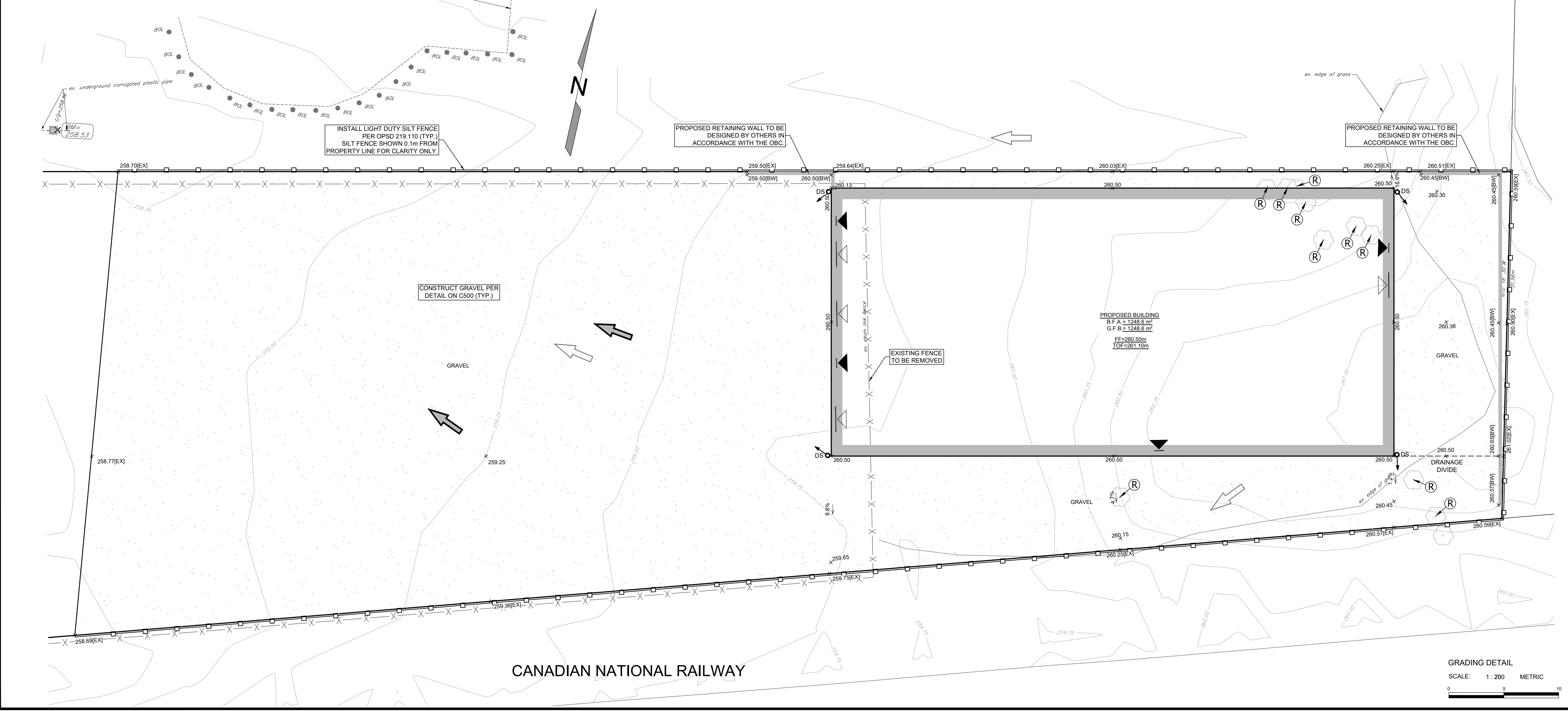

**BELMONT FARM SUPPLY
NEW BUILDING**

PROJECT INFORMATION: 14000 BELMONT ROAD, BELMONT, ONTARIO

BELMONT FARM SUPPLY

CLIENT INFORMATION: 14000 BELMONT ROAD, BELMONT, ONTARIO

DRAWING NAME:
**SITE GRADING,
EROSION AND SEDIMENT
CONTROL PLAN**

PROJECT No:
GE23-0612-1

DRAWING No:
C300

SCALE:
AS NOTED